

A SpeedCell bay requires the use of pallet rack beams and posts. Please reference your SpeedCell Configuration drawing for the exact layout and quantities for parts/hardware.

Your SpeedCell assembly kit includes:

1. 1/4"- 20 Serrated Flange Nuts
2. 1/4"- 20 x 3/4" Grade 5 Carriage Bolts
3. SpeedCell Crossbeams
4. SpeedCell J-Channels
5. SpeedCell Hangers
6. Bumpers
7. 1/4"- 20 x 3/4" Hex Head Bolts
8. Tek Screws

Tools required for assembly:

- Drill/Driver with Clutch
- Socket Wrench
- 7/16" Socket
- 5/16" Nut Driver
- Socket Adapter
- Swivel Socket
- 3" Extension

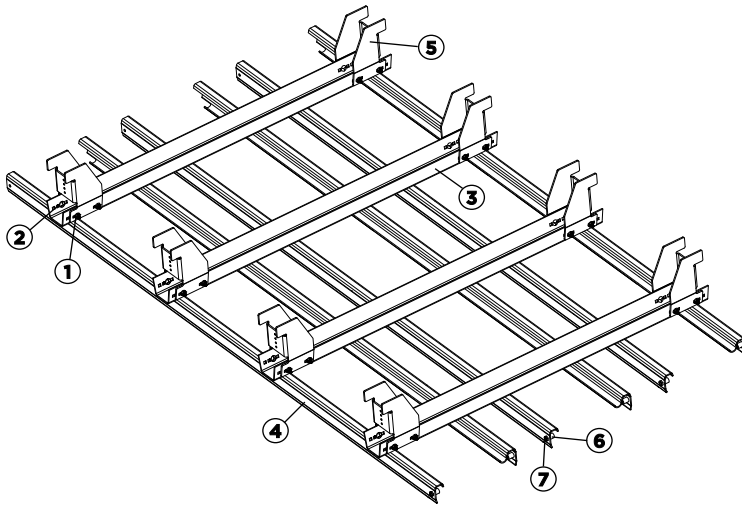

1 Attach outer J-Channels to crossbeams. Measure corner to corner to check squareness of assembly before fully torquing hardware.

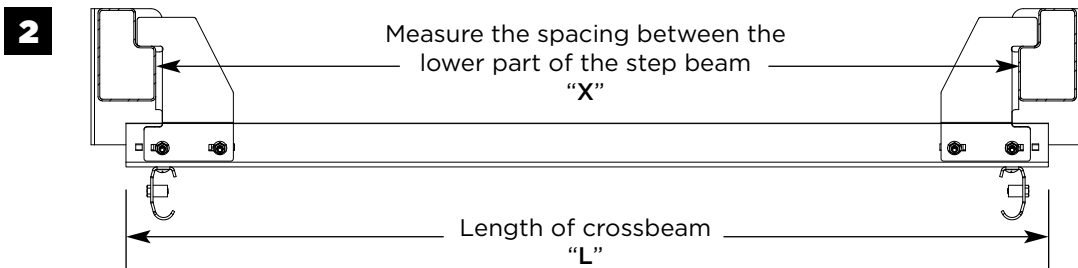
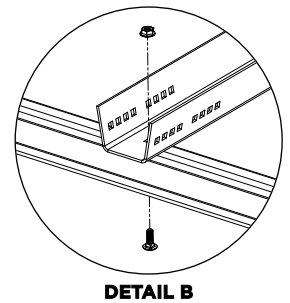
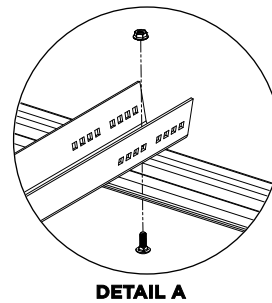
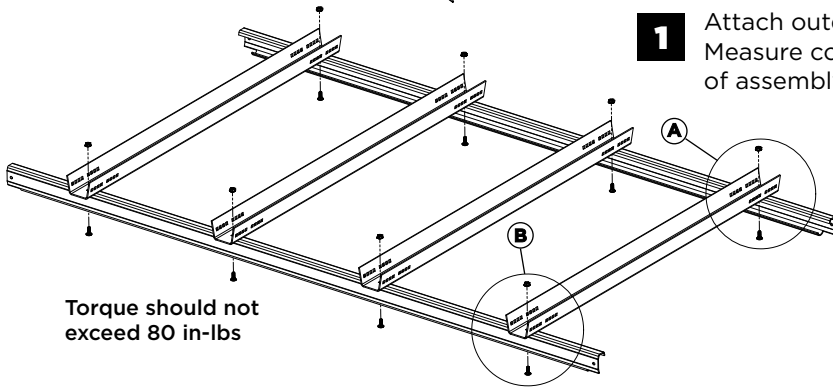

Using the formula $L - X$, match the result with the range on the right to attach the hanger using the correct group of holes.

Example: $40 - 37 = 3$ >>> Use group C holes.

A)	■□□□ ■□□□	□□□□ □□□□	0.25 - 1.25
B)	□■□□ □■□□	□□■□ □□■□	1.26 - 2.25
C)	□□■□ □□■□	□□□□ □□□□	2.26 - 3.25
D)	□□□■ □□□■	■□□□ ■□□□	3.26 - 4.25

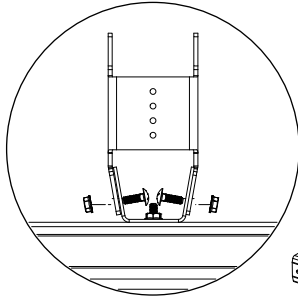

DETAIL C

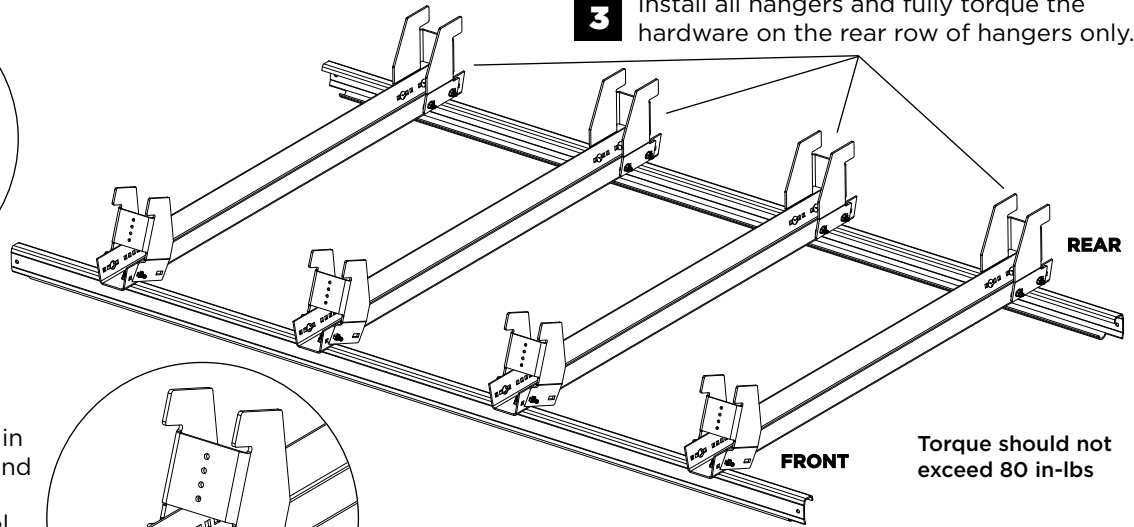

3 Install all hangers and fully torque the hardware on the rear row of hangers only.

Torque should not exceed 80 in-lbs

4

Install outer hardware in front row of hangers and tilt inward as shown. This will allow the steel set to clear support beams and be placed into the racking.

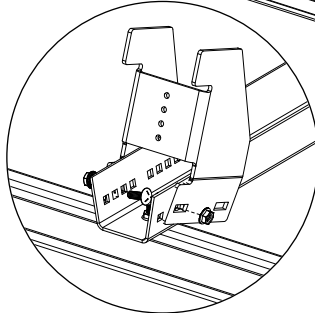

DETAIL D

5

Before placing the steel into the racking, be sure there is 90" clear under the bottom of the step beam. Place assembled SpeedCell steel set onto step beams of rack. Use one Tek screw and the most appropriate pilot hole in all hangers. Install inner hardware in front row of hangers as shown.

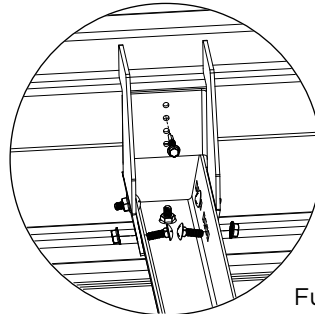

DETAIL E

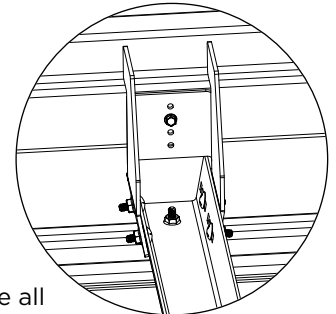

DETAIL F

Fully torque all hardware after Tek screws are installed.

6

Attach remaining J-Channels.

7

Install Bumpers on one end of J-Channels. Repeat on other end after installing SpeedCell columns.

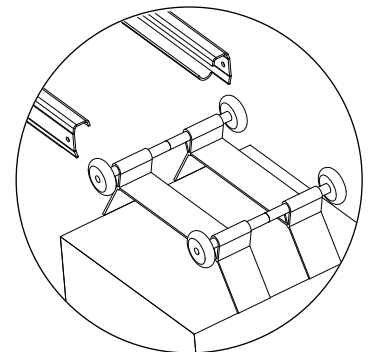
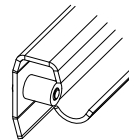
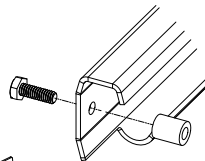
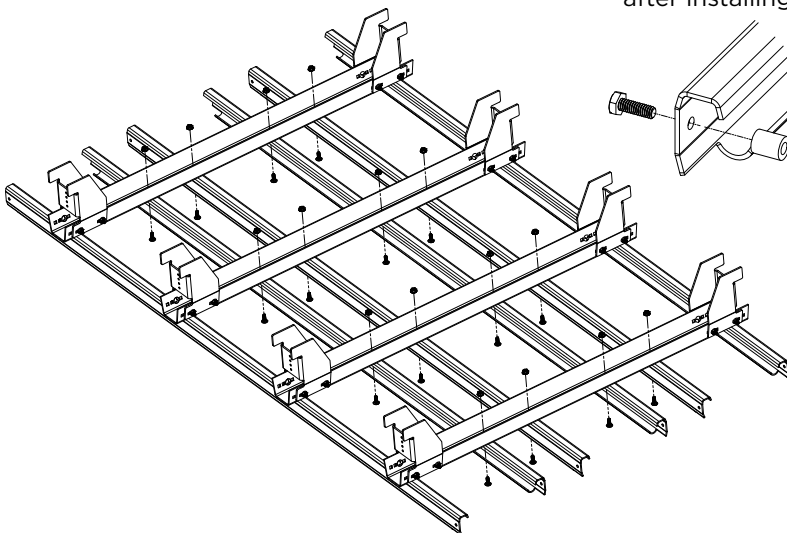

8

Slide SpeedCell columns into the J-Channels, starting with the back row. Install all columns into the bay.

Ensure the black nylon webbing is properly aligned on the cylindrical conduit on top of the SpeedCell column.